

Add efficiency products to your home.

~~\$145~~ **\$99** Energy Saving Starter Package

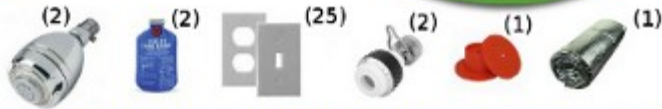

Energy efficient products don't cost you money, they **MAKE** you money

Visit us online at www.DropYourEnergyBill.com



**American Dream
Windows &**



America's Leader in
Energy Efficient Replacement and
New Construction Windows and Doors
www.americandreamwindow.com

236 E. Main St. #120 Sevierville, TN 37862

1-877-224-1447



Air Purification Unit

User Guide

*Bring that
"after the rain"
Freshness indoors*

Please read all of the information provided in this user's guide before operating your new air unit.

WARNING

This air unit is not a medical device. Do not stop or alter any medical therapy programs or medications without the advice of your physician. Excessive ozone concentrations may cause mucous membrane or respiratory irritation.

CAUTION

RISK OF ELECTRICAL SHOCK DO NOT OPEN

Caution: TO REDUCE THE RISK OF ELECTRICAL SHOCK, DO NOT REMOVE BACK COVER. NO USER SERVICEABLE PARTS INSIDE. REFER SERVICING TO QUALIFIED SERVICE PERSONNEL.



This "bolt of lightning" indicates that **uninsulated** material within your unit may cause an electrical shock. For the safety of everyone, do not remove product covering.



This "exclamation point" calls attention to a feature for which you should read the enclosed literature carefully to prevent operating and maintenance problems.

produced by the burning of fossil fuels. When ultraviolet rays from the sun strike hydrocarbons, O_3 is one of the by-products. Ozone is easily detected and is sometimes used as a reference point for the level of pollutants.

Q. How does it compare to air filters?

A. Fresco does not rely on the air to actually pass through the machine to be cleaned like air filters. It's not a filter at all. Fresco produces both activated oxygen which reduces odors and negative ions which settles out particulate.

Q. Is ozone safe?

A. Yes, but moderation is the key. Ozone in very high concentrations can be irritating to mucous membranes and the respiratory system. We recommend you set the Square Feet dial properly. The three different models equate to the approximate size of space to be purified. Before using the Fresco you should read the enclosed instructions carefully. Refer to Using a Timer section.

Q. Where should I place the Fresco in my home or office?

A. The Fresco should be placed in the room where you have the most pollutants. The Fresco is easy to move so you might want to try it in a couple of locations to help decide what works best for your environment. An elevated location is better to distribute ions and activated oxygen more evenly.

Q. How long will the Fresco last?

A. The Fresco is made of stainless steel and solid wood construction. Because of the quality material and superior craftsmanship that goes into each Fresco you will enjoy it for many years.

Q. Is it difficult to install?

A. No. Just plug it in and set the dial for the area you will be treating. Install the Fresco in any room, but try to find a place where it can be up off the ground four feet or more. Some customers prefer to have more than one unit to better control levels of activated oxygen in the home.

COMMONLY ASKED QUESTIONS

Q. What does the Fresco do?

A. It treats the air in your home or office by breaking down odor causing pollutants and dropping airborne particulate from your breathing space.

Q. How does the Fresco treat the air?

A. The Fresco produces ozone and negatively charged ions, the same effective cleansing agents that nature uses to treat outdoor air.

Q. How does the Fresco work?

A. It is a two-stage process

The Fresco uses a needlepoint ionizer to drop dust, smoke, and other harmful particles from the air we breathe. In our homes and offices there is a lack of negative ions and an abundance of positive ions. The buildings we spend most of our time in block out the natural occurring negative ions. The Fresco recreates the natural balance of positive to negative ions to significantly re-duce airborne particulate.

The Fresco uses electricity to split oxygen O_2 molecules into single O_1 atoms, which attach loosely to other O_2 molecules to be-come O_3 (activated oxygen). This loosely attached oxygen atom is unstable and seeks to bond with chemical compounds and other odor causing pollutants in order to oxidize them.

Q. How does nature produce ozone?

A. Ozone is created electrically during active thunderstorms. The electrical discharge creates a fresh sweet smell. The ultra-violet rays of the sun striking hydrocarbons in our atmosphere also creates ozone.

Q. How does nature produce ions?

A. Waterfalls, lightning, and the waves of the ocean all create negative ions.

Q. What is an ozone alert?

A. Ozone alerts in cities are a result of the high pollution levels of hydrocarbons

Congratulations...on your purchase. You have obtained a state-of-the-art air purification system with stainless steel construction and solid wood cabinetry. Regardless of your color choice, the cabinet has been hand crafted to fine furniture standards. Only the finest materials surround the finest art purification technology. We Hope that you will enjoy your purchase for years to come.

Thank you from all of us at Fresco!

Read ALL instructions carefully

Before using this product.

10 Day Money Back Guarantee!

*25% restock fee if returned after 10 trial period

FOR YOUR RECORDS

Please record the model and serial number below, for easy reference, in case of loss or theft. These numbers are located on the back panel of your air purification unit. Space is also provided for the other relevant information.

Model Number _____

Serial Number _____

Date of Purchase _____

Purchased From _____

Understanding the Model 3500 Air Purifier

(Front View)

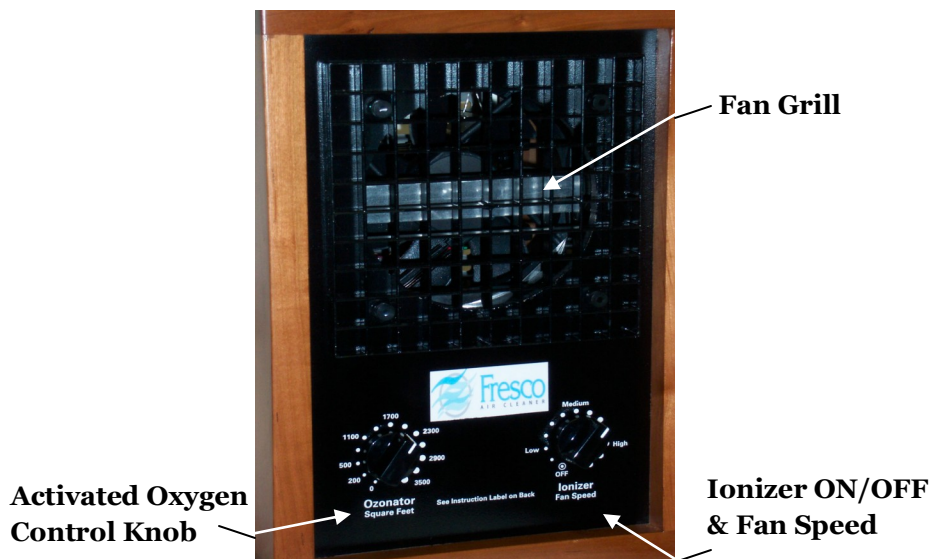

PART	FUNCTION
Ionizer ON/OFF & Fan Speed	On/Off control switch activates needlepoint Ionizer and controls the fan speed.
Ozonator Square Feet	Adjusts ozonator by square footage of treatment area. Number displayed on dial is a suggested starting point. The unit should be adjusted to meet user needs and sensitivities.
Fan Grill	Removable fan grill. Wash with warm soapy water, dry completely before replacing. (Unplug unit before removing)

Control for the negative ion generator is from the activated oxygen control. Negative ions can be created around the clock to keep down dust and particulate.

Ozone or activated oxygen is normally kept at modest levels in occupied spaces. To remove heavy odors, the units may be adjusted to a higher level for a period of time. Some use a timer to completely deodorize the home or office while away. Unused O₃ reverts back to O₂ in about an hour.

CLEANING & MAINTENANCE

When the purifier no longer produces enough ozone to be effective, the ozone plate should be cleaned. A good rule of thumb is every three months. Some environments cause ozone output to be reduced in a shorter time but other environments may take longer.

To clean a plate, first turn the unit **Off** and **unplug** from outlet. Then remove the 4"x4" plate or plates from back of unit. Pull plates firmly in the center to remove from the slot. With plate firmly supported in the hand, wash plate with warm soapy water or a grease cutting detergent. Scrub with stiff brush if necessary. Be careful not to drop the plate or scrub off the silicon. Clean both the metal screen and the ceramic tile. Rinse plate in hot water and **dry completely** before installing. If available, you may use a hair dryer to dry the plate. Reinstall plate, making sure it is secured and flush with the back of the unit. Plug unit into a grounded 110 electrical outlet, turn unit on and start enjoy-ing clean fresh air.

To clean needlepoint ionizer, first turn Off and **unplug** from outlet. Remove the fan grill cover. The needlepoint ionizer will be easy to find in front of the fan by looking for two pieces of wire. Take a q-tip or cotton swab dipped in alcohol and clean any dirt that may have accumulated on the needlepoint's. This process may be done when plates are being cleaned. While you have the front grill cover off the unit you may also clean the fan and the grill itself. To clean the fan simply wipe the blades with a damp cloth or vacuum. The grill cover may also be cleaned with warm soapy water. Be careful that the fan grill cover is completely dry before reinstalling.

TROUBLESHOOTING

If you suspect a problem with your unit check the following:

- Make sure plate is clean (see above).
- Unit is plugged in properly and turned on.
- Check the fuse to make sure it is installed properly and not burned out. To replace fuse, push in and turn fuse holder to the left, remove old fuse, replace with spare. Use 1 amp fuse, 1.25 inches long.
- Wall outlet is active.
- Check plate alignment, making sure the ceramic plate is almost flush with back of unit.
- It important that the Fresco be properly grounded to avoid potential shock.

If the fan is not operating or no buzzing sound is detected on the high setting of the Ozonator dial, call the Warranty Service Number listed on the back of unit.

Caution: No attempt should be made to remove the back panel of the unit, as there are no user serviceable parts. Opening the unit will void all warranties.

USING A TIMER

Some users who are sensitive to ozone set their units up on a timer so that the purifier does its work only when they are away from home. This allows for a higher setting and higher concentrations which can be more effective for purging purposes. The ozone will normally dissipate in less than an hour after the purifier is turned off. Simple timers plug into an outlet and are available at hardware and variety stores.

WHERE TO USE?

- Homes & living areas
- All types of offices & stores
- Water & fire damaged areas
- New paint, wallpaper & paneling
- Odor clean-up
- "Sick" buildings
- Hospitals & nursing homes
- Veterinary offices
- Smoking areas
- Hotel rooms
- High pollen environment
- New carpet & furniture
- Kitchens
- Attics & basements
- Laundry rooms
- Doctors' offices
- Day care centers
- Stables & aviaries
- Locker rooms
- Restaurants & bars

SERVICE

Should you determine that your air unit requires service, please call the 877-224-1447 as listed on the back panel of the unit.

WARRANTY

Your air unit comes with a 3 year limited warranty from the date of original purchase. Refer to enclosed warranty card for complete details. Please complete and return the warranty registration card within ten days of date of purchase in order to activate your **warranty**.

* 25% restock fee if returned after 10 day trial period

Understanding the Model 3500 Air Purifier

(Back View)

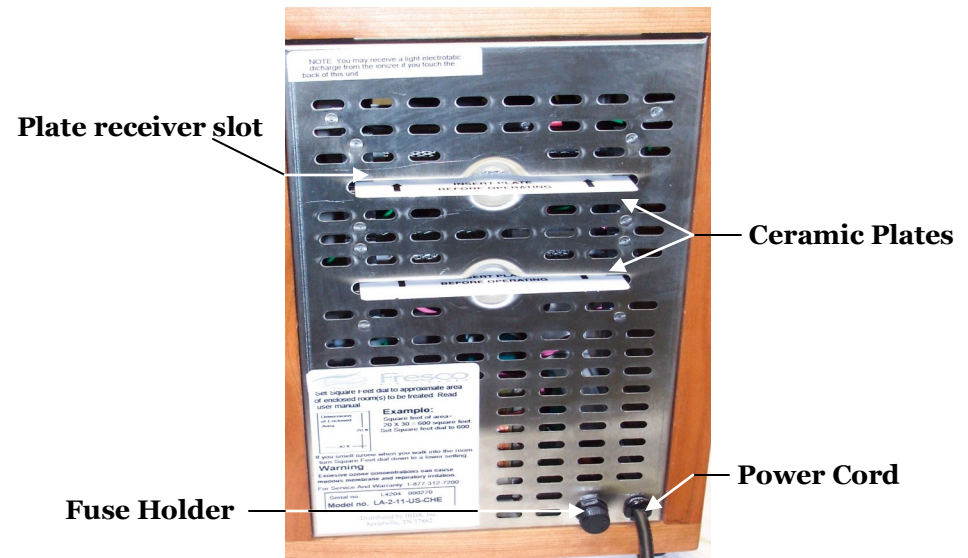

PART	FUNCTION
Plate receiver slot	Allows insertion and removal of ceramic plates for cleaning.
Fuse Holder	Houses removable fuse. (Spare fuse included, 1 amp, 1.25 inch)
Power Cord	110 Volt grounded cord (unless otherwise specified). DO NOT bypass ground.
Ceramic Plates	Removable ceramic plates. Wash with warm soapy water. Rinse and dry completely before replacing.



This unit must be provided with an electrical ground at all times!

OPERATION/INSTALLATION

- Start with the Fresco on its lowest Square Feet setting and turn the Ozonator dial “up” as necessary. The ideal amount of activated oxygen will leave your room smelling clean and fresh. If the unit is set too high, you will smell the ozone. If it set too low, you will smell household odors.
- The lonizer is designed to run independently from the activated oxygen production. The ionizer can be used around the clock to keep down dust and particulate. Ozone, however, should be kept at modest levels in occupied spaces. Ozone’s primary application is to control odors. The level of ozone may be adjusted according to the severity of the odors in the home or office. Many users put the purifier on a timer so it can run at high levels while being away. The timer is set to cut off about one hour before the occupants are scheduled to return. The O₃, that is not used normally reverts back to O₂ in about an hour. When they arrive the air is fresh and clean.
- Individual sensitivity to activated oxygen and preference may vary and should be adjusted accordingly. The effect of activated oxygen on indoor air may vary according to atmospheric and/or environmental conditions such as altitude, humidity, air movement, severity of existing odors, house design, and square footage.
- If you desire to treat the entire home with the same level of ozone, set the fan switch on your home’s heating & cooling system to the ON position rather than AUTO. Open all interior doors and adjust the activated oxygen level to the appropriate square footage. Then place the unit so the air from the purifier flows directly into a air return vent.
- **Altitude:** Generally, in higher altitudes the requirement for activated oxygen decreases. Therefore, higher altitudes should require lower settings.
- **Humidity:** Generally, in higher humidity the requirements for activated oxygen increases. Therefore, increased humidity may require higher settings.
- For optimal treatment of air in your designated area, your new air purification unit should be placed in a central location (higher is better). Your unit can be set on a tall piece of furniture. Allow three inches between the back of your unit and the wall to allow proper airflow. Fan speed is normally set in the medium range. The reason for elevated placement of the unit is that activated oxygen is heavier than air. Elevated placement allows for better circulation. It is suggested that the purifier be placed in the room that is close to the primary source of odor.

DETERMINE YOUR SQUARE FOOTAGE

Here’s how to determine the Square Feet Setting for your home or office:

- Measure total area of each room to be treated.
- Add area of room(s) together for total area to be treated. Note: If doors are open to another room, add that area also. Measure total enclosed area.
- The customer may use more than one Fresco Air unit in order to better control levels of activated oxygen in different areas of your home or office.
- The concentration of ozone will be higher in the immediate area of the unit.

Example: To determine the total square feet of area to be treated.

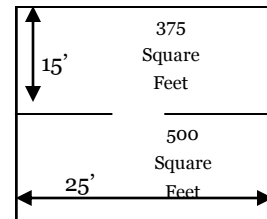

$$375+500=875 \text{ square feet}$$

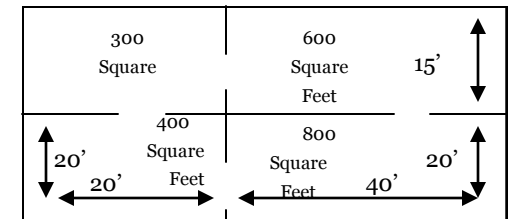

$$300+400+600+800=2,100 \text{ square feet}$$

Warning: Excessive ozone concentrations may cause mucous membrane or respiratory irritation and can be harmful.

Recommend us to a friend .

877-224-1447